

Mounting Bracket

Model **CWF-001, CWF-002**

INSTRUCTION MANUAL

Installation
Operation

- Notice to Customer** Thank you very much for purchasing our PATLITE product.
- Request the installation and wiring be performed by a professional contractor if construction work is involved.
 - Prior to installation, read this manual thoroughly before using this product to ensure correct use.
 - After reviewing this manual, if there are any questions regarding this product, please contact the nearest PATLITE office listed at the end of this manual.
- Notice to Contractor**
- Read this manual carefully prior to installation.
 - Be sure to return this manual to the customer.

Safety Precautions

In order to prevent any damage to the user and other personnel or to assets, note the following:
 ◆ The indications for warning are divided into the following classes according to the degree of danger or damage incurred when the warning is not taken into consideration and the product is not correctly used.

- | | | | |
|----------------|--|----------------|---|
| Warning | Indicates an imminently dangerous condition: failure to follow the instructions may lead to death or serious injury. | Caution | Indicates a potentially dangerous condition: failure to follow the instructions may lead to slight injury or property damage. |
|----------------|--|----------------|---|

◆ The following symbols indicate and explains the nature of the information to be observed.

- ⊘ This symbol indicates "Prohibited", which should not be carried out by all means.
- ⚠ This symbol indicates "Enforced", which should be observed and carried out by all means.

Warning

- | | |
|--------------------------|---|
| ⊘
[Prohibited] | <ul style="list-style-type: none"> • Do not disassemble or modify this product. (Type CWF LED Work Light) • After installing this product to the machine etc, do not operate it with the cover removed or use it as step-ladder when climbing onto the machinery. Failure to comply may result in falling off the machinery or product damage may occur. |
| ⚠
[Enforced] | <ul style="list-style-type: none"> • Be sure to disconnect the power from the LED Work Light when wiring, mounting, exchanging, or repairing the product. • Request the installation and wiring to be accompanied by a professional contractor. Failure to comply may result in electric shock, fire, or falling from high places. • Verify the installation location is a firm location which can handle the weight of the product and has no adverse vibrations. If installed in a place where vibration is frequent and/or exceeds the specifications, damage to the product may occur. |

Caution

- | | |
|--------------------------|--|
| ⊘
[Prohibited] | <ul style="list-style-type: none"> • This Attachment Bracket is specially made for the TYPE CWF (LED Work Light), only. |
|--------------------------|--|

Compatible Models Type CWF (LED Work Light)

1 Part Names and Dimensions

■ CWF-001

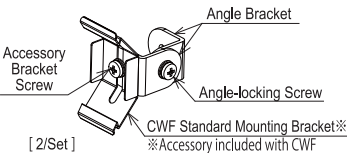

Accessory	
Cross Recessed Pan Head Screw with Spring Washer (M4×10)	2 pcs.

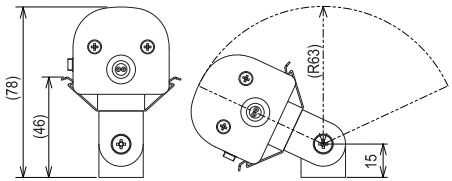

■ CWF-002

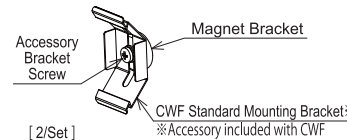

Accessory	
Cross Recessed Binding Head Screw (M4×8)	2 pcs.
Spring Washer	2 pcs.
Plain Washer	2 pcs.

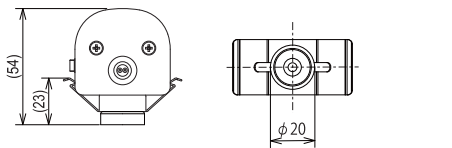

■ CWF Dimensions (Reference)

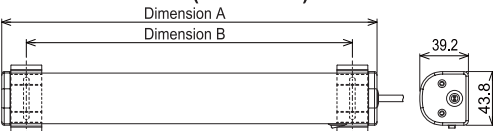

[Dimensions]

Model	Dimension A	Dimension B	Dimension C
	Body Length	Bracket Pitch	Mounting Pitch
CWF3S-□-CD	300	260	256
CWF6S-□-CD	600	560	556
CWF9S-□-CD	900	860	856

2 How to Install

■ CWF-001

- Loosen the "Angle-locking Screw" for CWF-001.
 - Rotate the angle by 90 degrees.
 - After tapping the mounting holes onto a flat and sturdy surface, use two M4 screws for mounting.
 - Attach an M4 screw in the "Mounting Hole" and tighten.

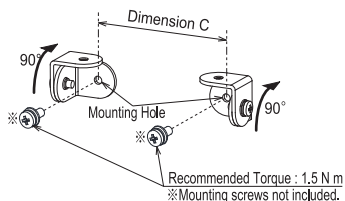

- Attach the CWF to the CWF-001.
 - After the bracket is mounted to a sturdy surface, snap the CWF into place.

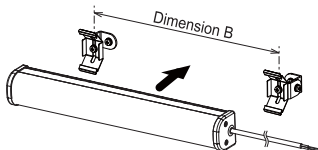

- Rotate angle by 90 degrees.
 - Attach the bracket to the angle using the M4 screws.
 - CWF-001 bracket assembly completed.

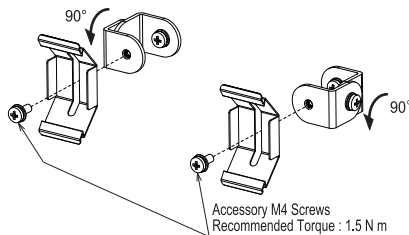

- Adjusting for the Fixed Angle.
 - Tighten "Angle-locking Screw" after adjusting the angle. (Adjust both of the CWF-001 brackets to the same angle.)
 - Use a screwdriver to tighten the "Angle-locking Screw" with a recommended torque of 1.5 N-m.

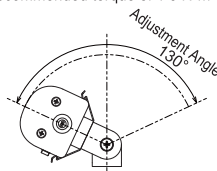

■ CWF-002

- Attach the bracket.
 - Attach the bracket to the magnet using the M4 screws.
 - CWF-002 bracket assembly completed.

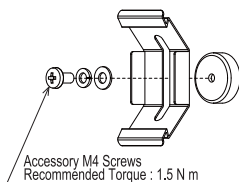

- Attach the CWF to the CWF-002.
 - After the bracket is mounted to a sturdy surface, snap the CWF into place.

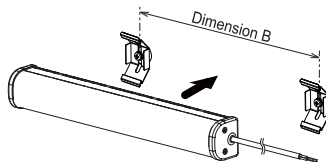

3 Specifications

Model	CWF-001	CWF-002
Compatible Models	Type CWF (LED Work Light)	
Material	SUS	Neodymium Magnet
Mounting Location	Indoor Only	
Mounting Direction	All Directions	
Mass (Tolerance $\pm 10\%$)	26 g (1 pcs.)	11 g (1 pcs.)
Quantity	1 pair	

PATLITE Corporation G2G

PATLITE Corporation ※Head office ■<http://www.patlite.com/>
 4-1-3, Kyutaromachi, Chuo-ku, Osaka 541-0056 Japan

PATLITE (U.S.A.) Corporation ■<http://www.patlite.com/>
PATLITE Europe GmbH ※Germany ■<http://www.patlite.eu/>
PATLITE (SINGAPORE) PTE LTD ■<http://www.patlite.cn/>
PATLITE (CHINA) Corporation ■<http://www.patlite.cn/>
PATLITE KOREA CO., LTD. ■<http://www.patlite.co.kr/>
PATLITE TAIWAN CO., LTD. ■<http://www.patlite.tw/>
PATLITE (THAILAND) CO., LTD. ■<http://www.patlite.co.th/>

(Note) ● Dimensions and specifications may change without notice due to continual product improvement.
 ● PATLITE and the PATLITE logo is a trademark, or registered trademark of the PATLITE Corporation of Japan and each country.

O95100080 | A
 '17.10 UBC