

Sir	
Caratteristiche tecniche/Technische Hauptdaten/Technical specifications	
Tipo attuatore/ Actuator typ/ Actuator type	AL-LIFT
Tipo motore / Mototyp / Motor type	Brushless
Forza massima assiale / Max Achsiale Druckkraft / Max thrust load	850 N
Carico max a 800mm di sbraccio / Max off-side load at 800mm	450 N
Corsa / Hub / Stroke	700 mm
Velocità/ Geschwindigkeit/ Speed	80 mm/s (No load)
Voltaggio / Spannung / Voltage	24 Volt
Sensori di finecorsa / Endschalter / End-stroke limit switches	2
Ip / Schutzart / Ip	X0
Servizio / Aussetzbetrieb / Duty cycle	S3 10%

● Cobot attachment customizable

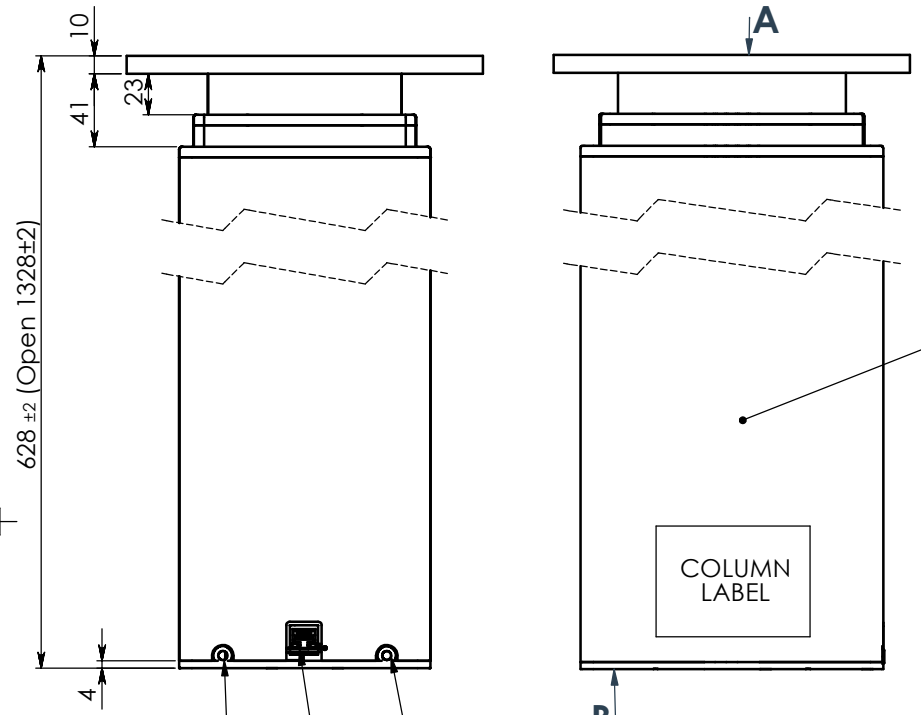

Alimentation cable  
Lenght 330±30mm  
Brown = +24V  
Blue = GND

Control cable 3x0.5mm<sup>2</sup>  
(Deactivated)

MODBUS comunication  
TCP/IP (Ethernet)

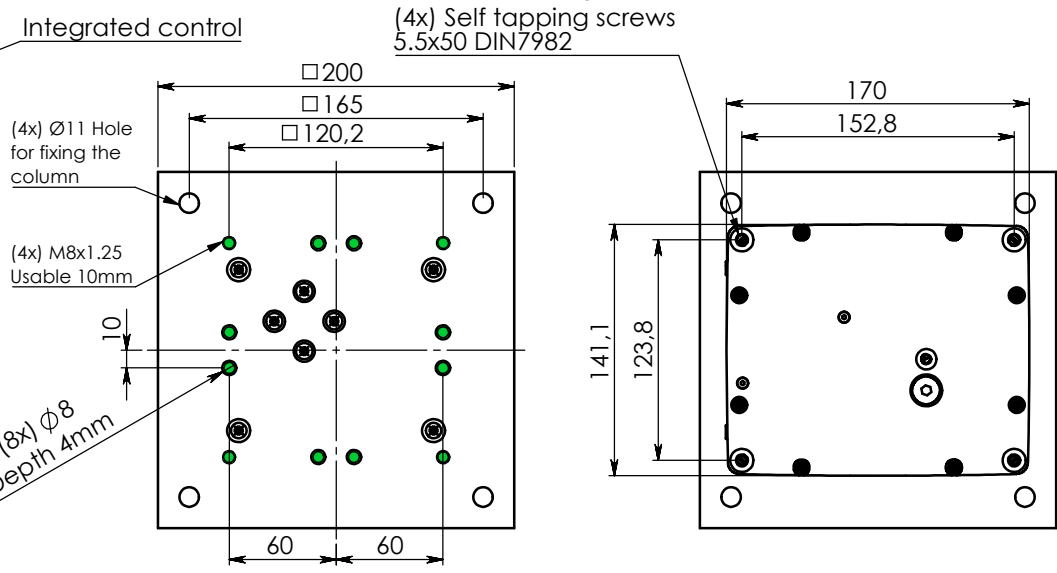
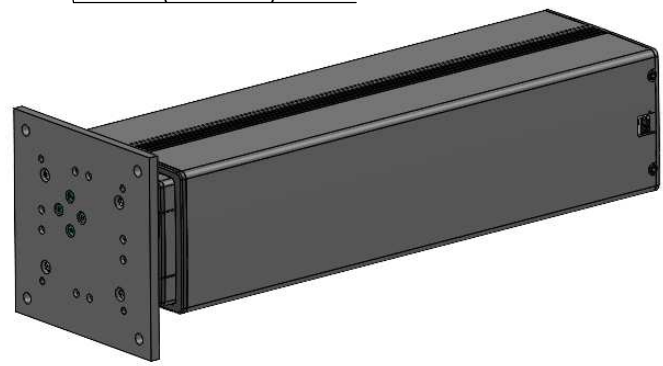

VIEW A

VIEW B

Firma/Signature		Data/Date			Scala/Scale	Formato/Size	Materiale/Material Cod.:														
Disegnato/Drawn		Haas			1:5		A3														
Verificato/Checked				Metric format: unless otherwise specified, dimensions are in millimeters, dimensions between [ ] are in inches				Trattamento/Treatment													
Modificato/Modified				Unless otherwise specified tolerances references: UNI EN 22768/1 m - UNI EN 22768/2 K				Sampo/Mold													
Approvato/Approved				<b>LINEAR LENGTHS</b> <table border="1"> <tr> <td>&gt;6</td> <td>&gt;30</td> <td>&gt;120</td> <td>&gt;400</td> <td>&gt;1000</td> <td>&gt;2000</td> </tr> <tr> <td>...6</td> <td>...30</td> <td>...120</td> <td>...400</td> <td>...1000</td> <td>...2000</td> </tr> </table>				>6	>30	>120	>400	>1000	>2000	...6	...30	...120	...400	...1000	...2000	Denominazione/Title	
>6	>30	>120	>400	>1000	>2000																
...6	...30	...120	...400	...1000	...2000																
				<table border="1"> <tr> <td>±0.1</td> <td>±0.2</td> <td>±0.3</td> <td>±0.5</td> <td>±0.8</td> <td>±1.2</td> </tr> </table>				±0.1	±0.2	±0.3	±0.5	±0.8	±1.2	AI-LIFT CC V24 C700 S80 M2+D 4M8							
±0.1	±0.2	±0.3	±0.5	±0.8	±1.2																
				ISO METRIC THREADS Male 6g Female 6H				Codice/Code													
				ANGLES ±1°				DCM4170													
				HOLES ±0.1				Rev. A													
								Rif./Ref.													

**sir**  
attuatori riduttori motoriduttori

SIR Srl  
I-36078 Valdagno (Vicenza) - Italy  
Via Gasdotto, 65  
Ph. +39 0445 430780  
www.siractuators.com

This document is proprietary to Sir S.r.l. and shall not be used or disclosed to others without the written authorization of Sir S.r.l.