

Serie 940 Stecker 6 / 8 / 9-polig, für Crimpkontakte
Series 940 Plug 6 / 8 / 9-pin, crimp version

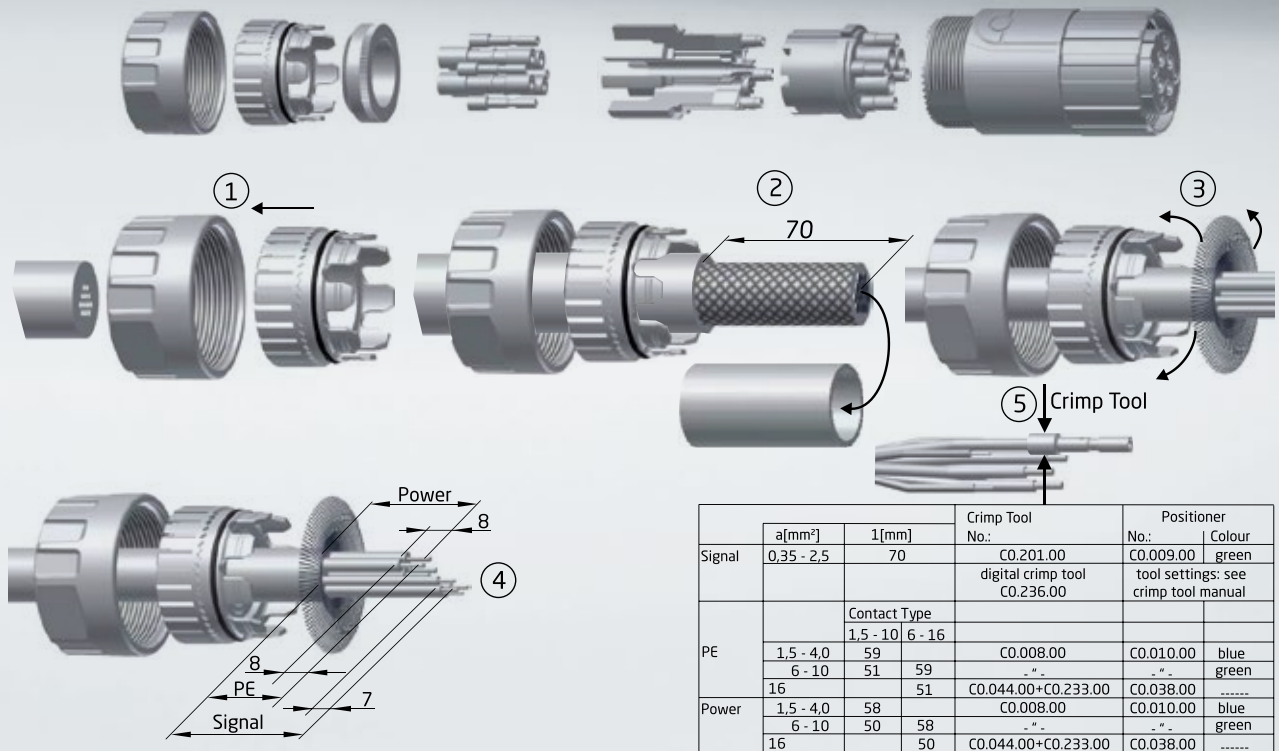

	a[mm²]	1[mm]	Crimp Tool No.:	Positioner	
Signal	0,35 - 2,5	70	C0.201.00	No.:	Colour
			digital crimp tool C0.236.00	tool settings: see crimp tool manual	
PE		Contact Type 1,5 - 10 6 - 16			
	1,5 - 4,0	59	C0.008.00	C0.010.00	blue
	6 - 10	51 59	- " -	- " -	green
Power	16	51	C0.044.00+C0.233.00	C0.038.00	-----
	1,5 - 4,0	58	C0.008.00	C0.010.00	blue
	6 - 10	50 58	- " -	- " -	green
	16	50	C0.044.00+C0.233.00	C0.038.00	-----

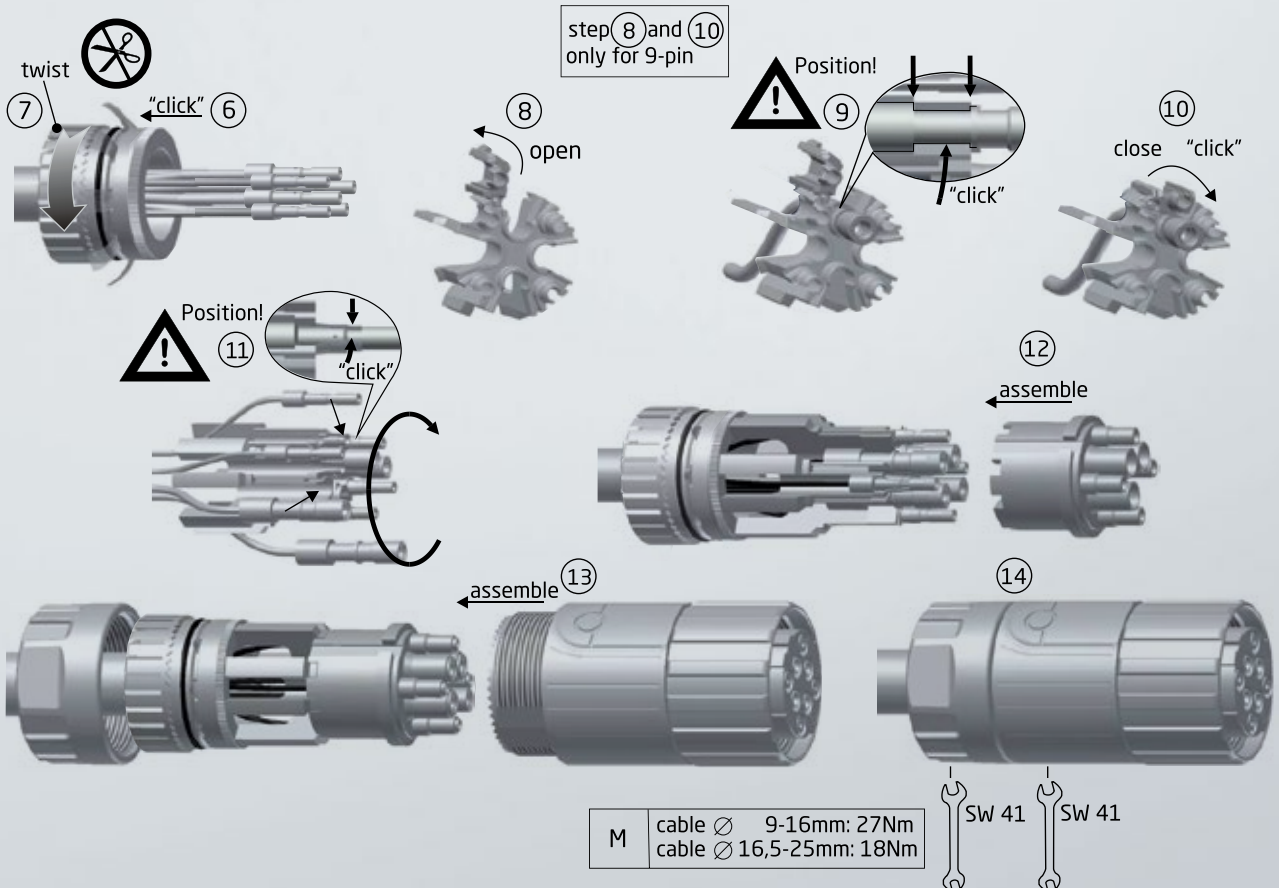

Serie 940 Kupplung 6 / 8 / 9-polig, für Crimpkontakte Series 940 Extension 6 / 8 / 9-pin, crimp version

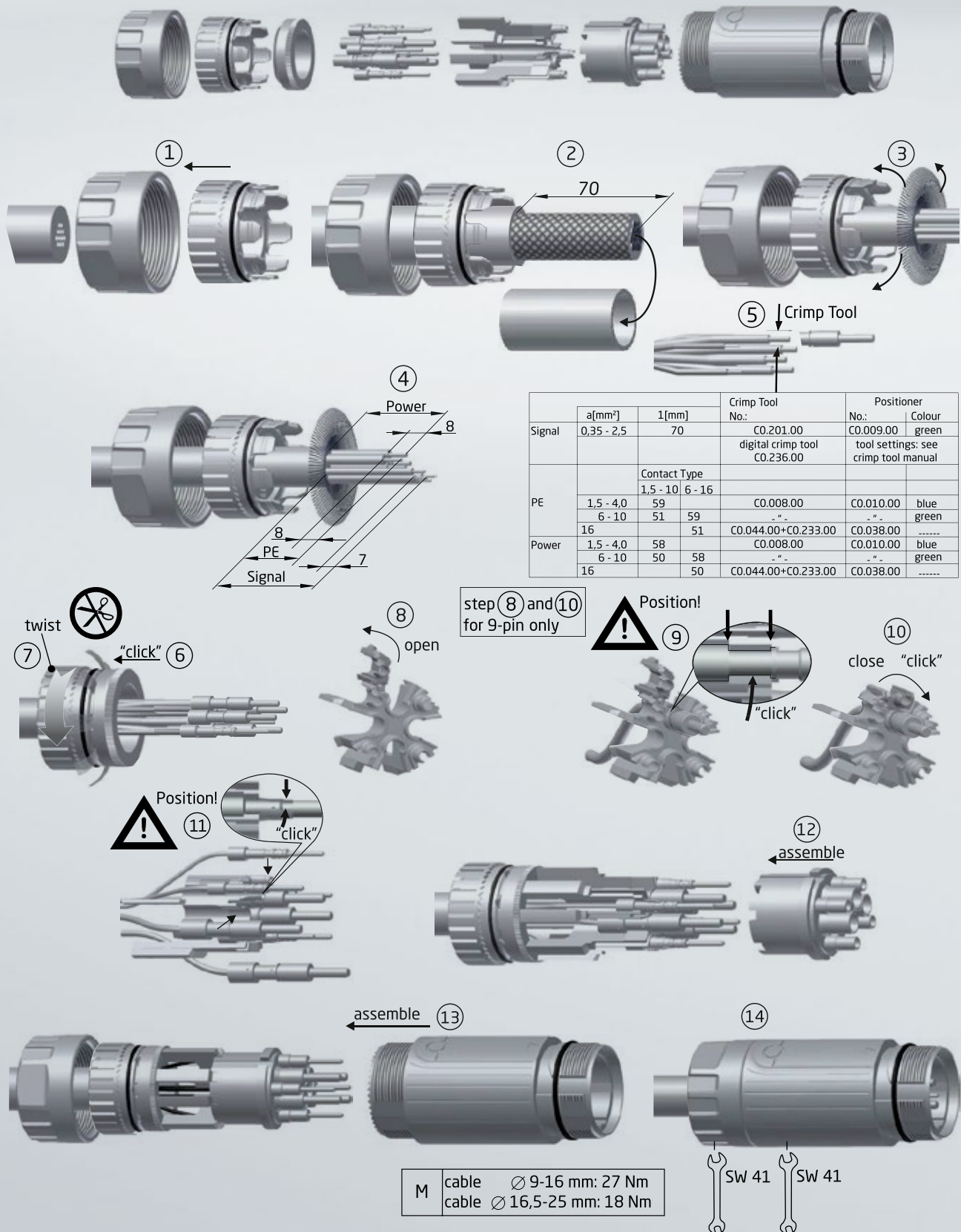

Serie 940 Winkelstecker, 6 / 8 / 9-polig, drehbar
Series 940 Plug Angled, 6 / 8 / 9-pin, rotatable

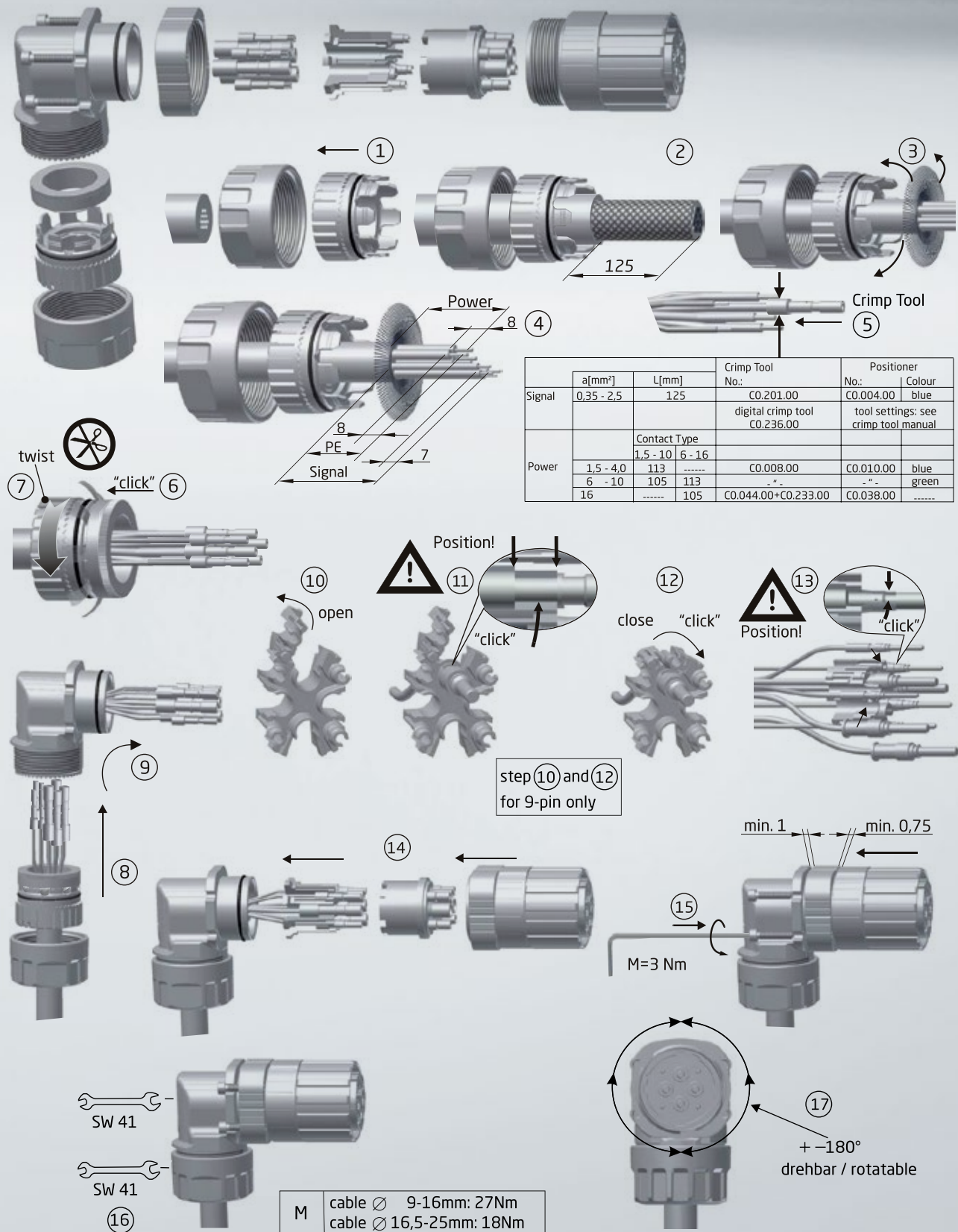

Serie 940 Winkelkupplung speedtec® / speedtec®-ready, 6 / 8 / 9-polig, drehbar
Series 940 Extension Angled speedtec® / speedtec®-ready, 6 / 8 / 9-pin, rotatable

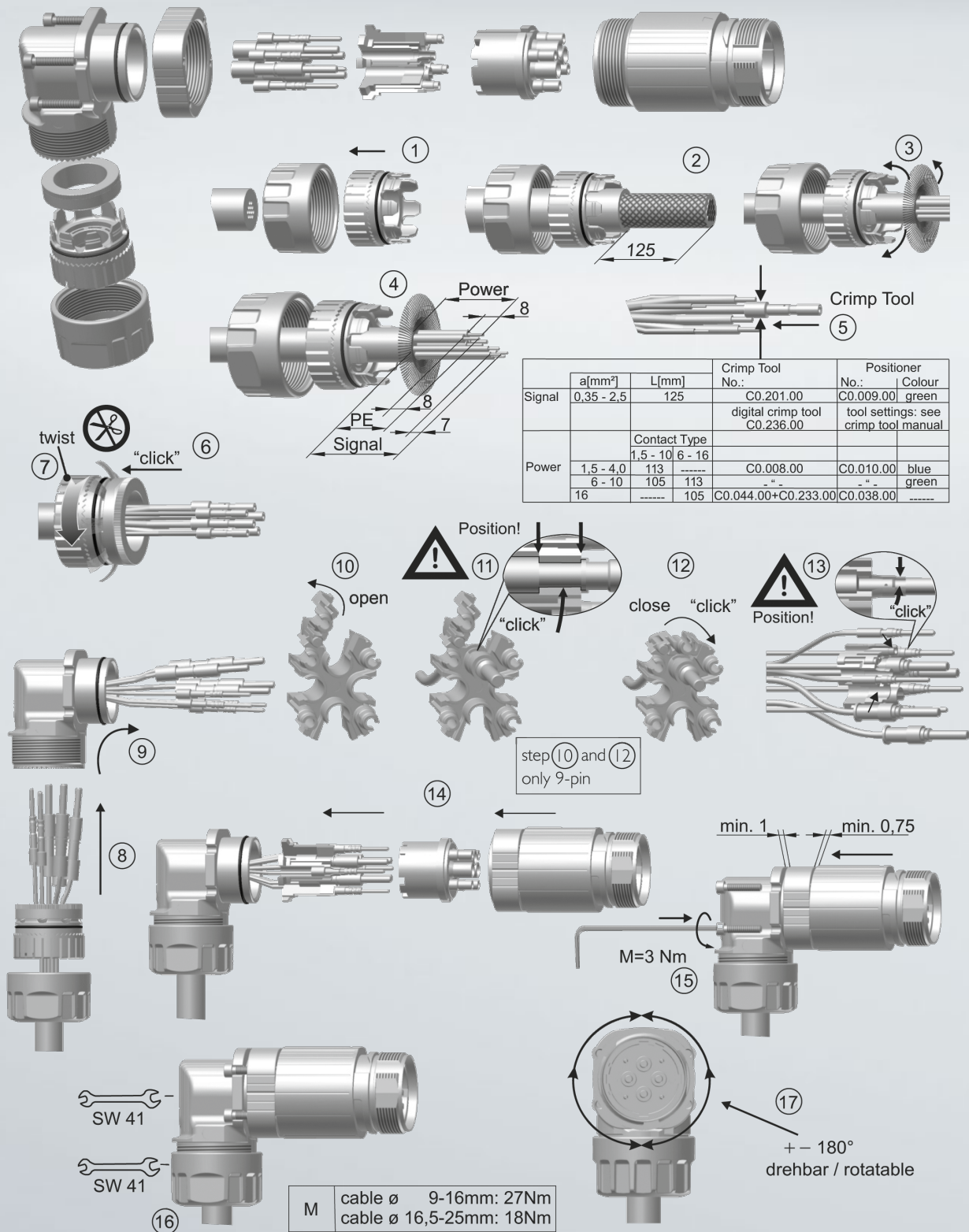

Serie 940 Durchführung, Größe 1,5, für Crimpkontakte Series 940 Bulkhead Connector, size 1.5, crimp version

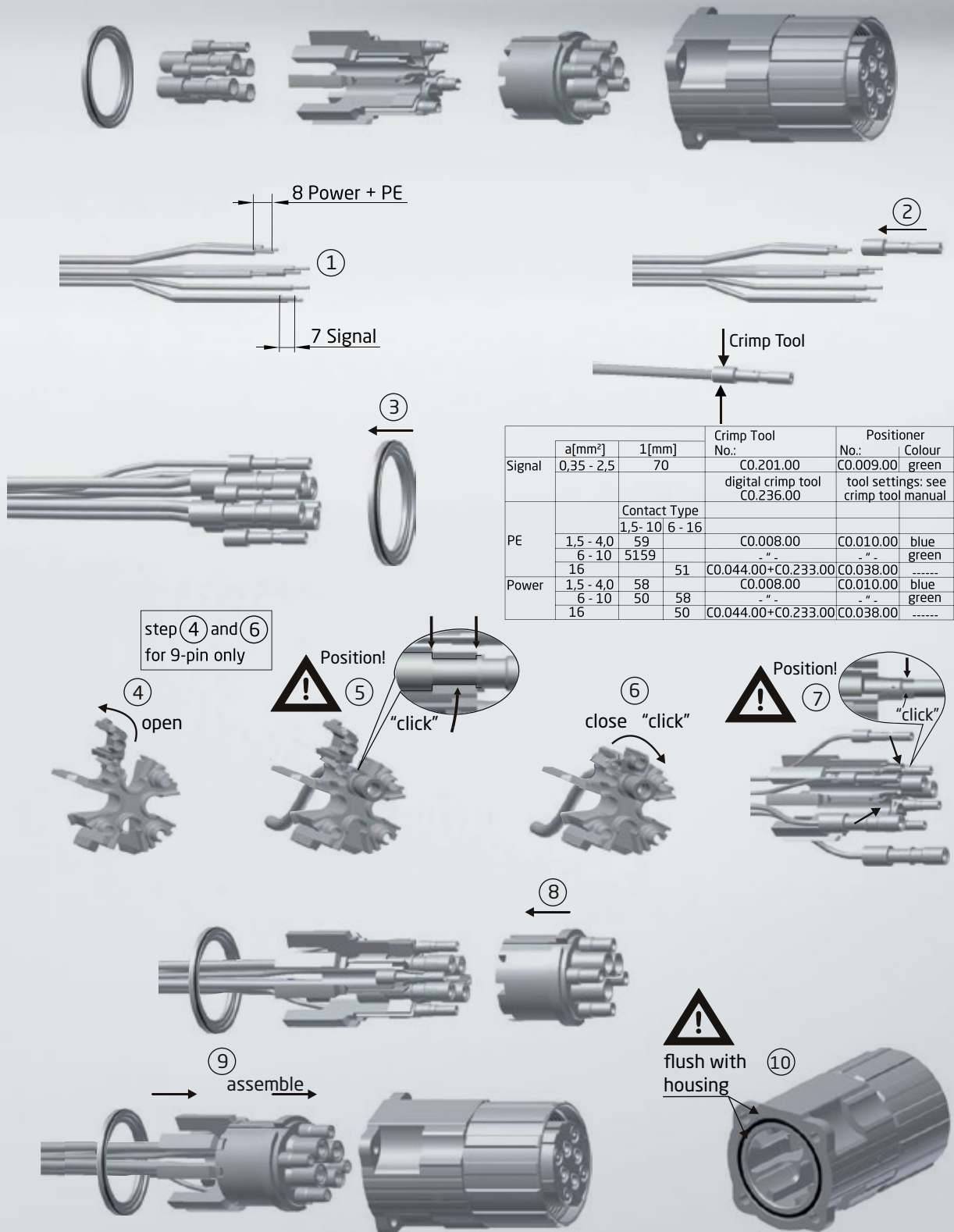

Serie 940 Einbaudose speedtec® / speedtec®-ready 6 / 8 / 9-polig
Series 940 Receptacle speedtec® / speedtec®-ready 6 / 8 / 9-pin

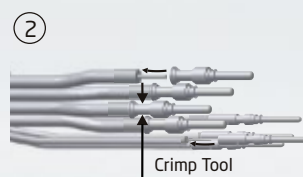
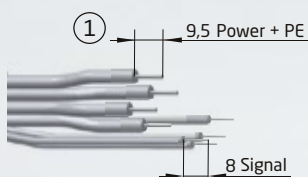
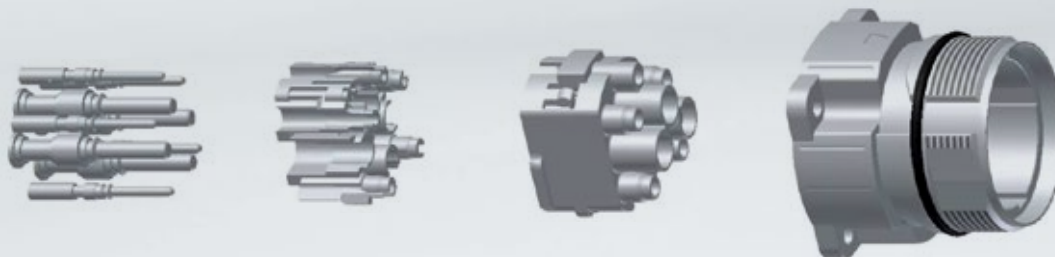

	Crimp Tool No.	Positioner No.	Colour
Signal	C0.201.00	C0.009.00	green
PE/Power	C0.008.00	C0.247.00	blue
	digital crimp tool C0.236.00	tool setting; see crimp tool manual	

step ③ and ⑤
for 9-pin only

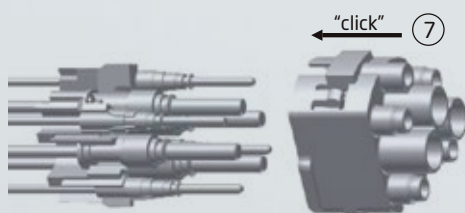
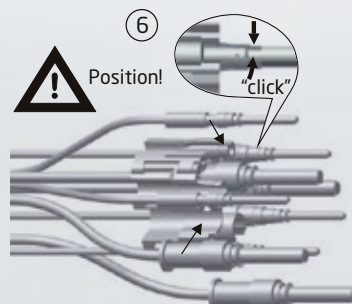
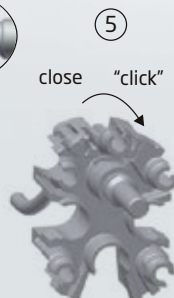
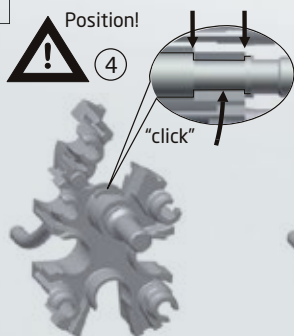

! flush with housing

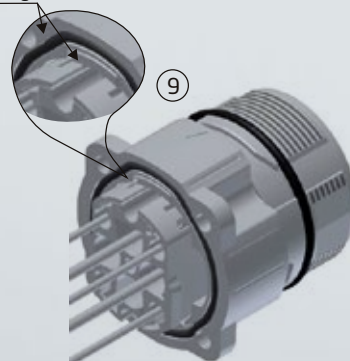
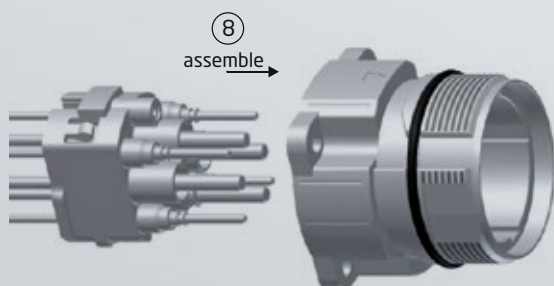

Serie 940 Winkeleinbaudose 6 / 8 / 9-polig, für Crimpkontakte, drehbar
Series 940 Receptacle Angled 6 / 8 / 9-pin, crimp version, rotatable

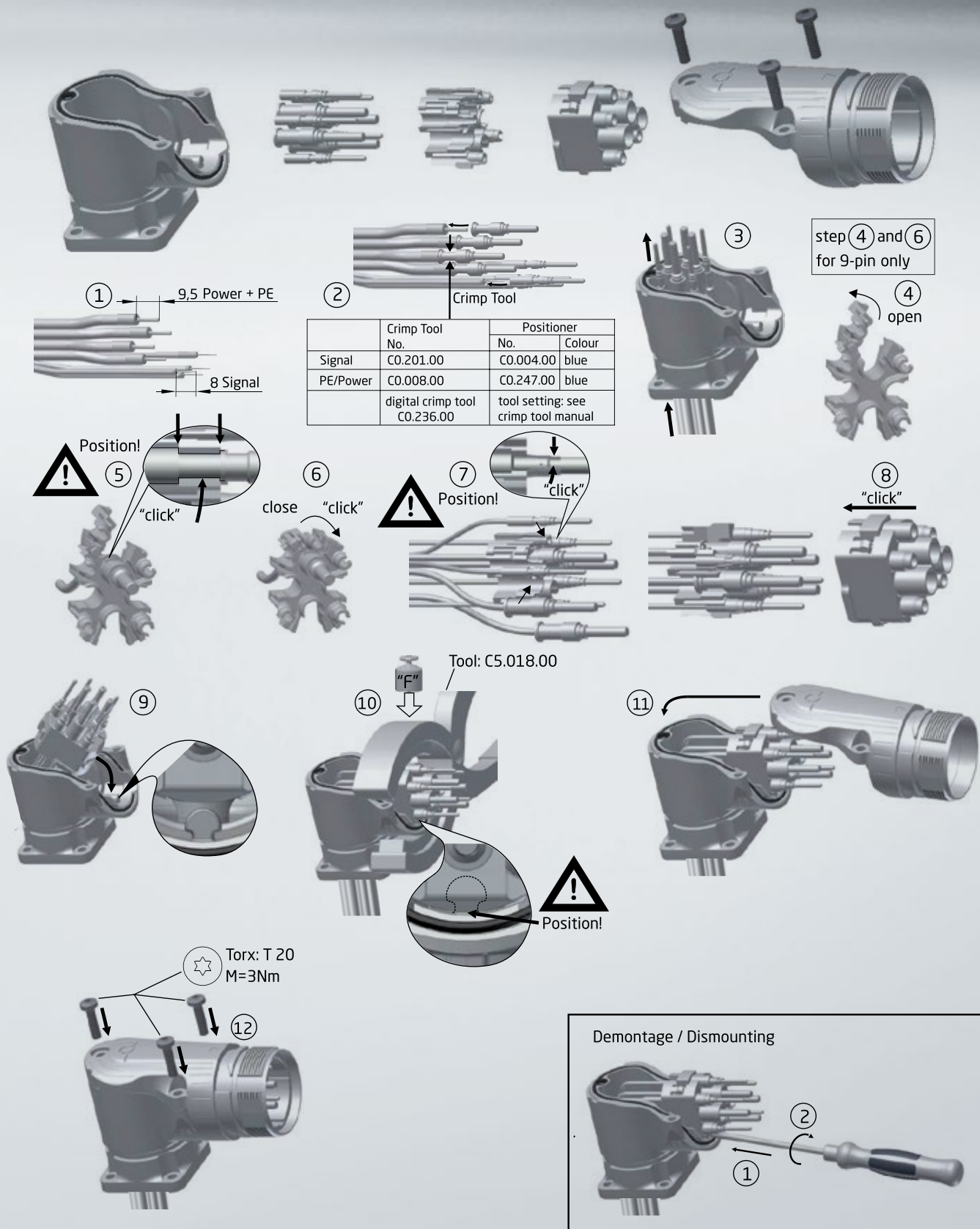

Serie 940 Winkeleinbaudose 6 / 8 / 9-polig, 16 mm²
Series 940 Receptacle Angled 6 / 8 / 9-pin, 16 mm²

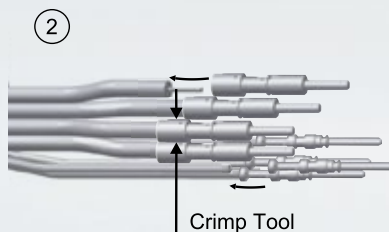
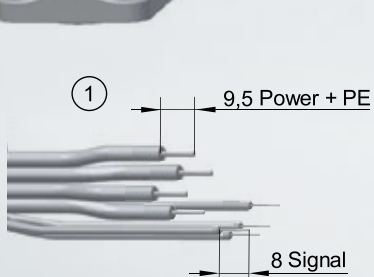
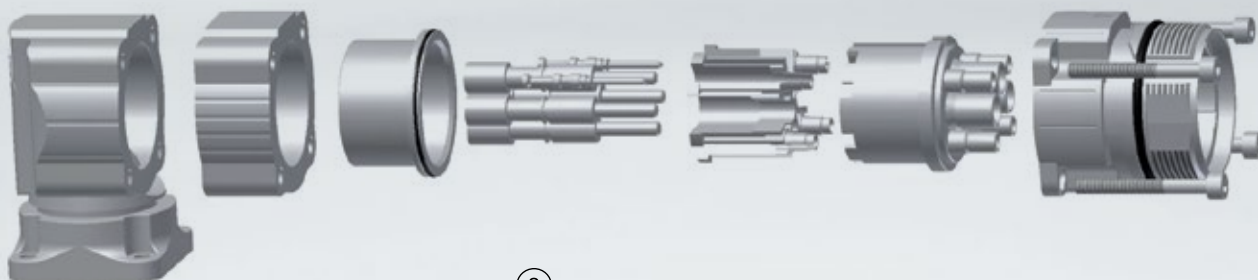

	Crimp Tool No.	Positioner	
		No.	Colour
Signal	C0.201.00	C0.009.00	green
PE/Power	C0.008.00	C0.010.00	blue
	digital crimp tool C0.236.00	tool settings see crimp tool manual	

